

NOTICE INVITING TENDERS

for the supply, installation and
commissioning of Science Laboratory
Furniture

| |
|--|
| NIT No.:109/2026 |
| NIT issue date: 03/01/2026 |
| Last Date & Time of Submission of Bid: 24/01/2026, 3 PM |



Rabindranath Tagore University

(A State University established Vide ASSAM ACT NO. XXXIV of 2017)

PO & District: Hojai. PIN 782435, Assam.



ৰবীন্দ্রনাথ ঠাকুর বিশ্ববিদ্যালয়

Rabindranath Tagore University

(A STATE GOVT. UNIVERSITY RECOGNISED UNDER 2(F) OF UGC)

Hojai-782436, Assam, India

Phone – 7002418574, 7086031120 (M)

website – www.rtuassam.ac.in : email – rabindranathtagoreuniversity@gmail.com, rtuacademicregistrar@gmail.com

NOTICE INVITING TENDER

NIT No: 109/2026

Date: 03/01/2026

Sealed tenders are invited from reputed manufacturers / authorized suppliers, in two bids systems (separate **Technical bid** and **Financial bid**), in the prescribed proforma, for the **supply, installation and commissioning of Science Laboratory Furniture** for the following departments of Rabindranath Tagore University, Hojai, Assam:

- Botany
- Chemistry
- Physics
- Zoology

1. Name of Work

Supply, Installation and Commissioning of Science Laboratory Furniture for Physics, Chemistry, Botany and Zoology Laboratories of Rabindranath Tagore University, Hojai, Assam.

2. Location of Work

Rabindranath Tagore University, Hojai, Assam – 782435.

3. Earnest Money Deposit (EMD)

₹ 25, 000/- (Rupees Twenty-Five Thousand) only in the form of Demand Draft, drawn in favour of **Rabindranath Tagore University, Hojai** payable at Hojai.

4. Tender Fee

₹ 5, 000/- (Rupees Five Thousand) only (Non-refundable)

5. Time for Completion

Within **30 days** from the date of issue of Work Order.

6. Eligibility Criteria

- The bidder has to strictly adhere to RTU's necessities for the aforementioned laboratories. Page numbers 12 to 21 include the necessary specification.
- The bidder must be a registered firm with valid GST registration.
- The bidder must have at least three years' experience in supplying laboratory furniture to universities, colleges, or research institutions.
- Copies of GST certificate, PAN, and at least two similar work orders must be enclosed.

যত্ন বিশ্বম্ ভবত্যেক নীড়ম্



ৰবীন্দ্রনাথ ঠাকুর বিশ্ববিদ্যালয়

Rabindranath Tagore University

(A STATE GOVT. UNIVERSITY RECOGNISED UNDER 2(F) OF UGC)

Hojai-782436, Assam, India

Phone – 7002418574, 7086031120 (M)

website – www.rtuassam.ac.in : : email – rabindranathtagoreuniversity@gmail.com, rtuacademicregistrar@gmail.com

7. Submission of Tender

Completed tenders in sealed envelopes superscribed:

“Tender for Supply of Science Laboratory Furniture”

should reach the undersigned on or before:

Last Date & Time: 24 / 01 / 2026 at 3 PM.

8. Opening of Tender

Tenders will be opened on:

Date: 03 / 02 / 2026

Time: 11 AM

in the office of the Registrar, Rabindranath Tagore University, Hojai, Assam.

9. General Conditions

- The University reserves the right to accept or reject any or all tenders without assigning any reason.
- Conditional or incomplete tenders shall be rejected.
- Rates quoted shall be inclusive of all applicable taxes, transportation, installation, and commissioning charges.

Sd/-

Registrar

Rabindranath Tagore University

Hojai, Assam – 782435





ৰবীন্দ্ৰনাথ ঠাকুৰ বিশ্ববিদ্যালয়

Rabindranath Tagore University

(A STATE GOVT. UNIVERSITY RECOGNISED UNDER 2(F) OF UGC)

Hojai-782436, Assam, India

Phone – 7002418574, 7086031120 (M)

website – www.rtuassam.ac.in : email – rabindranathtagoreuniversity@gmail.com, rtuacademicregistrar@gmail.com

IMPORTANT INSTRUCTION TO BIDDERS

1. Delayed/Late Bids will not be accepted at any circumstances.
2. Date & time of opening of **Technical bid**: **03/02/2026, 11 AM**.
3. The **Financial bid** will be opened on a suitable date, will be intimated later by the Registrar, Rabindranath Tagore University in respect of those who qualify the terms and conditions of the technical bid.
4. The following documents to be submitted to participate in the bid:
 - a. TENDER ACCEPTANCE UNDERTAKING.
 - b. Demand draft of ₹ 25, 000/- (Rupees Twenty-five Thousand) only as EMD.
 - c. Demand Draft of ₹ 5, 000/- (Rupees Five Thousand) only as Tender fee.
 - d. Tender document (**all annexures**) with all pages duly signed and embossed with official seal.
 - e. Self-attested copy of Work Experience Certificate along with work order and completion certificate.
 - f. Self-attested copy of Certificate of Incorporation/Registration.
 - g. Self-attested copy of PAN Card.
 - h. Self-attested copy of proof of registration for GSTIN.
 - i. Any other documents the bidder feels necessary and appropriate.

(Details to be mentioned)
5. The University reserves the right to reject any, in part or all tender without assigning any reasons thereof.
6. All terms and conditions will be as per Rabindranath Tagore University rules, regulations and decisions.
7. The bidder shall be required to sign all the hardcopy of the bid documents with full signature with date & stamp. The bid should be accompanied by copy of bidders PAN card/Driving License/Equivalent document issued by Govt. for signature verification.

যত্ন বিশ্বম্ ভবত্যেক নীড়ম্



ৰবীন্দ্রনাথ ঠাকুর বিশ্ববিদ্যালয়

Rabindranath Tagore University

(A STATE GOVT. UNIVERSITY RECOGNISED UNDER 2(F) OF UGC)

Hojai-782436, Assam, India

Phone – 7002418574, 7086031120 (M)

website – www.rtuassam.ac.in : : email – rabindranathtagoreuniversity@gmail.com, rtuacademicregistrar@gmail.com

8. **Bid Validity:** The bid remains valid for **30 days** from the date of floating of tender, that is 03/01/2026.
9. **Fraud Warning Disclaimer:** Please be aware that certain individuals might approach bidders, by falsely presenting themselves as university employees, affiliates agents or representatives. Under this false pretence, they might try to gain access to your personal information or to acquire money or other valuables from you by offering fictitious opportunities related to the bid or by claiming that they are contacting on behalf of university authority. These claims and offers are fraudulent and invalid and bidders are strongly advised to exercise great caution when they receive such an offer related to bid or notice. Be very mindful of such scams as university shall not be responsible for, and expressly disclaims all liabilities for damages of any kind arising out of the use of, NIT reference, bid details or any information contained on the University website. For any clarification related to published bids on RTU website bidders are advised to contact the Registrar of the University.



SRatna
03/01/2026

(Dr. Sandip Ratna)

Registrar i/c

Rabindranath Tagore University

Registrar i/c

Rabindranath Tagore University

Hojai (Assam)

General Terms and Conditions

1. The quoting firm should submit the bid submission format as per Annexure-II along with the quotation for technical qualification.
2. The bid should be complete in all respects and should be **duly signed at every page**. Overwriting and corrections in the bid documents are not encouraged and, if any, should be attested properly. Incomplete and unsigned bids will not be considered.
3. In case, the certificate/information provided by the quoting firm is found false at any stage of the tender process or after the rate contract, the University will reject the bid or cancel the rate contract without any further intimation.
4. There will be no change in price structure during the currency of contract except of the taxes imposed by the government which are made applicable by the government through notifications / regulations change.
5. Prices charged for the items supplied should under no event be higher than lowest prices at which the party sells the items of identical description to any other Govt. organization / Private Organizations. In case it is found that the price charged by the firm is more, the same will be recovered from the subsequent/unpaid bill of the supplier.
6. Conditional, Unsigned, Late & Delayed tenders will not be accepted.
7. If the supplier fails to deliver the material within the delivery period as specified, purchaser may procure such items as deemed appropriate for.
8. The supplier will be liable to the purchaser for any excess costs incurred for procurement of goods or services not delivered in time.
9. The tenderer shall be fully responsible for the manufacturer warranty in respect of quality and workmanship of the materials. In case of any defects found at the time of use, the supplier will provide free replacement or refund the amount charged for that item(s).
10. The items supplied will have to be of high quality and grade and in the inspection/test if these are found to be of inferior quality, the same are to be replaced by supplier at their cost within the stipulated period, failing which the work order may be cancelled. Delayed supply/non-compliance of complete order may also lead to cancellation of the work order.
11. Bidders are requested to provide complete Bank details (as per **Annexure IV**) with branch code, Account No., IFSC so that payment can be sent electronically.
12. No advance payment will be made for the supplies.
13. Discount, taxes and other levies if any are to be specified clearly in the bid.

14. It is mandatory for all the bidding firms/manufacturers who are having online catalogue with dynamic pricing that, the price of an item obtained from their online portal on a date shall remain valid for a minimum period of two year.
15. In case of any modification in specifications / terms and conditions / any clarification to the bid document, it will be hosted in the university official website (<http://rtuassam.ac.in>) only and the bidders are requested to visit to Rabindranath Tagore University website from time to time and no separate notification/corrigendum will be issued in this regard.
16. Any dispute arising out of or in connection with this contract shall be subject to the exclusive jurisdiction of the competent Courts at Hojai, Assam only.
17. Rabindranath Tagore University reserves the right to reject any or all the tenders or to accept them in part or full.
18. The tenders are also liable to be rejected if the above conditions are not complied with.

Annexure - I

TENDER ACCEPTANCE UNDERTAKING (In the letterhead of the Bidder)

To,
The Registrar,
Rabindranath Tagore University,
Hojai - 782435, Assam

NIT No: 109/2026

Dear Sir,

I/we, the undersigned, hereby propose to submit the quotation in accordance with the terms and conditions specified in the tender document after reviewing the tender document for the **supply, installation and commissioning of Science Laboratory Furniture** for the following departments of Rabindranath Tagore University, Hojai, Assam. A Demand draft of ₹ 25, 000/- (Rupees Twenty-five Thousand) only (No....., Date.....) as EMD and ₹ 5, 000/- (Rupees Five Thousand) only (No....., Dt.....) as Tender Fee are enclosed herewith.

We further certify that,

i I/ we have gone through and understood the requirements given in the Rabindranath Tagore University NIT no., Dt..... and price list along with the discount, if any, have been quoted accordingly. The terms and conditions given in the tender notice are acceptable to me/us.

ii The price list/catalogue that is included with the tender documents is a standardized pricing list that is used across India. If prices decline during that time, we guarantee to transfer the benefit to Rabindranath Tagore University.

iii I/we have offered the maximum possible discount to you in this Quotation No. _____ dated _____.

iv The prices charged for the materials supplied will under no event be higher than lowest prices at which the party sells the items of identical description to any other Govt. organization/PSU's/Autonomous bodies/Pvt. Organizations. In case, if the price charged by our firm is more, Rabindranath Tagore University will have the right to recover the excess charged amount from the subsequent/unpaid bill of the supplier.

v The supplier/Manufacturer has not been blacklisted by any Government organization/department/Central Government/State Government funded autonomous bodies.

Date:

(Signature of Bidder)

Name:

Designation:

Seal:

(To be signed by a person competent and having the power of attorney to bind the same)

Annexure – II
Bid Submission Format

NIT No. 109/2026, Dated: 03/01/2026

| Sl. No. | Components | Bidder's Response | Remarks |
|---------|---|--|---------|
| 1. | Name of supplier | | |
| 2. | PAN No. | | |
| 3. | GSTIN | | |
| 4. | Category for which bid is submitted | | |
| 5. | Principal Manufacturer/Brand Name | | |
| 6. | Whether current price list is enclosed. (The firms are encouraged to provide the soft copy of the price list along with the hard copy) | | |
| 7. | Whether necessary supporting document has been enclosed | | |
| 8. | Whether all the authorization for all the manufacturers is enclosed | | |
| 9. | Discount offered on the printed price by manufacturer (<i>Yes/No</i>) | | |
| 10. | Total Discount offered | To be mentioned in the financial bid only | |
| 11. | The work has to be completed within one month from the issue of work order | No Deviation allowed | |
| 12. | Mention whether firm is currently under Black listing / suspension by any Govt. funded organization/universities. (<i>Yes/No</i>) | | |
| 13. | Whether you have read and understood all the tender terms and conditions and whether you accept it unconditionally. | | |

Date:.....

Signature of the competent authority with seal

Annexure – III

MANUFACTURER'S AUTHORIZATION FORM

Date:.....

Dear Sir,

I/We who are established and reputable manufacturers of do hereby authorize M/S (*Name and address of the Agent*) to submit a bid, negotiate and receive the order from you against your tender for the procurement of laboratory furniture.

I/We hereby inform you that I/we or our firm have not been blacklisted by any Government organization/department/Central Government/State Government funded autonomous bodies.

I/We hereby extend our full guarantee and warranty for the goods and services offered by the above firm.

Yours faithfully,

(Name)

(Name of the manufacturers) (Seal)

Note: This letter of authority should be on the letterhead of the manufacturer and should be signed by a person competent and having the power of attorney to bind the manufacturer.

Annexure – IV

BANK DETAILS REGARDING THE TRANSFER OF PAYMENT THROUGH NEFT/RTGS

Date: _____

To
The Registrar
Rabindranath Tagore University
Hojai – 782435. Assam.

NIT No: **109/2026**

Dear Sir,

We hereby inform you that the Bank Details for the transfer of payment for the supply of materials to Rabindranath Tagore University, Hojai – 782436, Assam are as follows:

| | | |
|-----|--|--|
| 1. | Name of the firm | |
| 2. | Contact person | |
| 3. | Contact No. of firm | |
| 4. | Email ID | |
| 5. | Name of Bank | |
| 6. | Name of Bank Branch | |
| 7. | Bank Address | |
| 8. | Bank Branch Telephone No | |
| 9. | 9 Digit Code Number of the Bank and Branch IFSC of the Bank Branch | |
| 10. | Bank account number (please attach a cancelled cheque) | |
| 11. | Type of Bank account | |

Signature of the competent authority with seal

Note: These above details should be on the **letterhead of the supplier** and should be signed by a person competent and having the power of attorney to bind the same.

Annexure – V

FINANCIAL BID FORMAT (To be submitted in a separate sealed envelope)

NIT No. 109/2026

Tender Name: *Supply, installation and Commissioning of Science Laboratory Furniture*

Bidder Name: _____

Address: _____

GSTIN: _____

Contact No.: _____

Email ID: _____

Schedule of Items and Prices:

I. For Botany Laboratory Furniture:

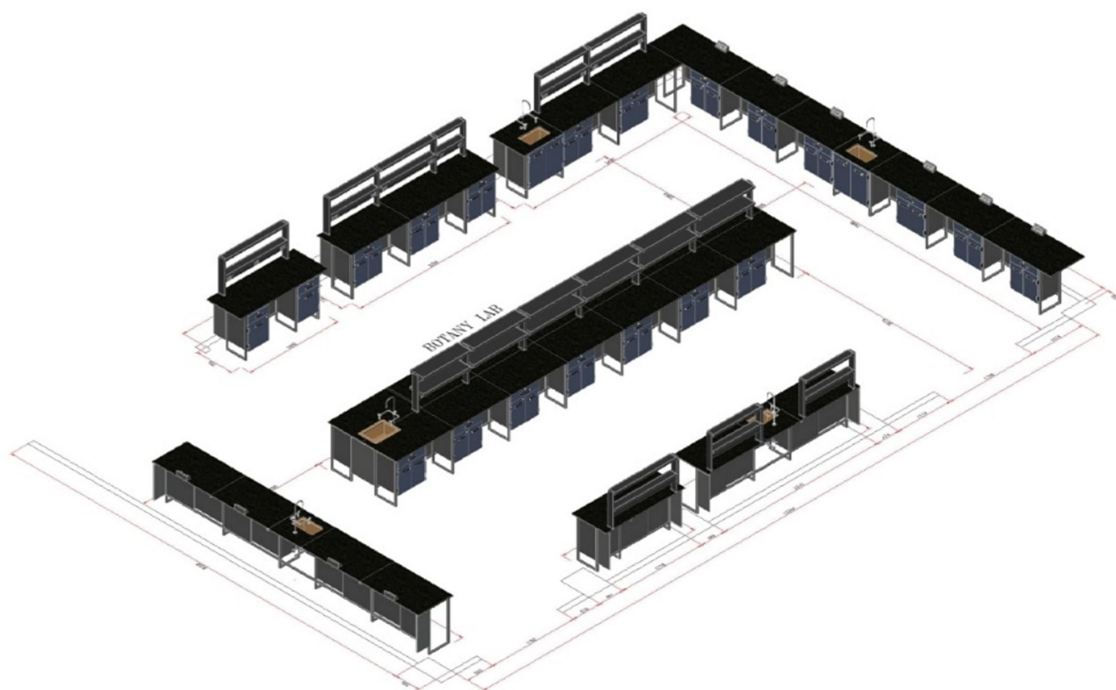

| S/N | Description of items with specifications | Qty | Unit | Rate/Unit | Total amount(₹) |
|-----|--|-----|------|-----------|-----------------|
| 1 | Wall table of 1900mmW*750mmD*900mmH Storage, Reagent Shelves as shown in the layout | 1 | | | |
| 2 | Wall table of 7250mmW*750mmD*900mmH Storage, Reagent Shelves as shown in the layout | 1 | | | |
| 3 | Wall table of 3450mmW*750mmD*900mmH Sink, Storage, Reagent Shelves as shown in the layout | 1 | | | |
| 4 | Wall Table of 7988mmW*750mmD*900mmH Sink, Storage, Reagent Shelves as shown in the layout | 1 | | | |

| | | | | | |
|---|---|---|--|--|--|
| 5 | Wall Table of 3310mmW*750mmD*900mmH Sink, Storage, Reagent Shelves as shown in the layout | 1 | | | |
| 6 | Wall Table of 1718mmW*750mmD*900mmH Sink, Storage, Reagent Shelves as shown in the layout | 1 | | | |
| 7 | Wall Table of 5780mmW*750mmD*900mmH Sink, Storage, Reagent Shelves as shown in the layout | 1 | | | |
| 8 | Island Bench 5000mmW*1500mmD*900mmH Sink, Storage, Reagent Shelves as shown in the layout | 1 | | | |

Sub Total:

- All D-Frames assemblies should be manufactured from standard hollow metal sections; confirming to I.S. Code 7138:1973 (Indian Standard specification for steel tubes for furniture) and all sheet metal components should be of CRCA confirming to IS Code 513:1994. The suspended under-bench welded units should be supported on heavy-duty steel frames fully carrying the load of worktops. Its superior strength combined with aesthetically appealing end caps shall give maximum flexibility and modularity while making a layout. D-frame should be constructed from a rectangular pipe with a cross section of 30mm x 30mm and should be a minimum 1.6 mm thick. The D-frame legs should be supplied with adjustable feet (tolerance from -5mm to +20mm) to correct the unevenness of flooring. The tubular enclosed type construction shall discourage dust accumulation and unwanted development of bacteria & fungus. Drainage gradient should be well adjusted throughout the length of table and should have horizontal supports for drainage systems... It should be suitable for sitting and standing nominal heights of 900MM, the nominal table depths should be 1500mm for Island tables. All frame-work is should be pre-treated with superior pure epoxy powder coated finish. The D-Frames should be for suspended storage cabinets.
- HORIZONTAL MEMBERS -These should be made from rectangular pipes of 2mm thickness. Cross-sectional dimensions of the pipe should be 30 x 30mm with a minimum of 1.6 mm. They should be made of CRCA MS and coated with pure epoxy powder. These connect two D-Frames together as shown using C-clamps/U-clamps. Together with the D-Frames and Horizontal Members connected together, the skeletal structure of the work-bench is formed on which the worktop can be placed and the hanging-type storage cabinets can be suspended. Horizontal Members determine the width of the lab workbench as they form the member (distance) between two adjacent D-Frames.
- COVER-PANELS: All side cover panels and back panels, filler panels should be made from CRCA MS panels of minimum 0.8mm thickness with pure epoxy powder coating.
- WELDED UNDER-BENCH STORAGE CABINETS- Under bench cabinets are Pure epoxy powder coated with thickness of 40-60 microns and are suspended from tubular structure, with an overlay shutter. The cabinet has a corrosion resistance magnetic strip as shutter catch, shutter and drawer are equipped with 180 degree cam lock. Semi recessed handle and SS-304 five knuckle overlay hinge with 270 degree opening
Unit Construction: Welded body with load bearing members such as top, bottom and stiffeners should have a minimum thickness of 0.8mm and drawer separator is 1.2mm thick.
Shelf: is made of 0.8mm thickness which is adjustable to 6 steps of 50mm. Shutter is over-closing with 270 degree opening. It has a sandwich construction with profile as a sound dampener.
Drawer: Welded filled with profile as sound dampener Single piece construction with an over closing drawer.
- REAGENT SHELVES: Fixed-Type reagent shelves should be provided. It should be complete modular design consisting of 2 stage horizontal storage shelves made of minimum 1.2 mm thick frame. CRCA MS with pure epoxy powder coating and having cutouts for electrical switches and sockets. It should have provision for placing Granite pieces (as per requirement in BOQ)
- Polypropylene Molded Sinks: Made up of 5 mm thick high density and elastic poly propylene with good resistance to organic solvents. Standard bowl size (L x W x D) is 500 x 400 x 300 mm. Faucet should be 1-way type faucet of approved make
- OEM Should Have SEFA Membership Certificates for Last four years on a continuous basis. Welded Cabinets should be tested for SEFA 8M from SEFA approved Lab and should be listed in SEFA's website also should be tested for EN 14727 by NABL approved Lab. And, adaptable work bench should be tested for SEFA 10 by SEFA approved Lab and should be listed in SEFA's website and also should be tested for EN 13150 by NABL approved Lab. The bidder/parent company should possess the key professional staff, at least one, in his organization with good knowledge of codes and standards like SEFA, OSHA, EN 14175, ASHRAE 110 and NFPA 45. Such professionals should have a valid membership of SEFA and in addition membership of any of the international governing standards. OEM should be present with warehousing facility in NE region since last 10 years. OEM should be a member of IGBC and should be certified under IGBC Green Existing building rating system, Platinum certified and Net zero energy building rating system

Taxes and Charges

| S/N | Particulars | Amount (₹) |
|-----|--------------------------------|------------|
| 1 | GST @% | ₹ |
| 2 | Packing & Forwarding | ₹ |
| 3 | Transportation | ₹ |
| 4 | Installation and Commissioning | ₹ |
| 5 | Any other charges (Specify) | ₹ |
| 6 | Total Taxes & Charges | ₹ |

Grand Total

| S/N | Particulars | Amount (₹) |
|-----|------------------------|-------------------|
| 1 | Sub-total | ₹ |
| 2 | Total Charges & Taxes | ₹ |
| 3 | Grand Total in Figures | ₹ |
| 4 | Grand Total in Words | Rupees only |

II. **For Chemistry Laboratory Furniture:**

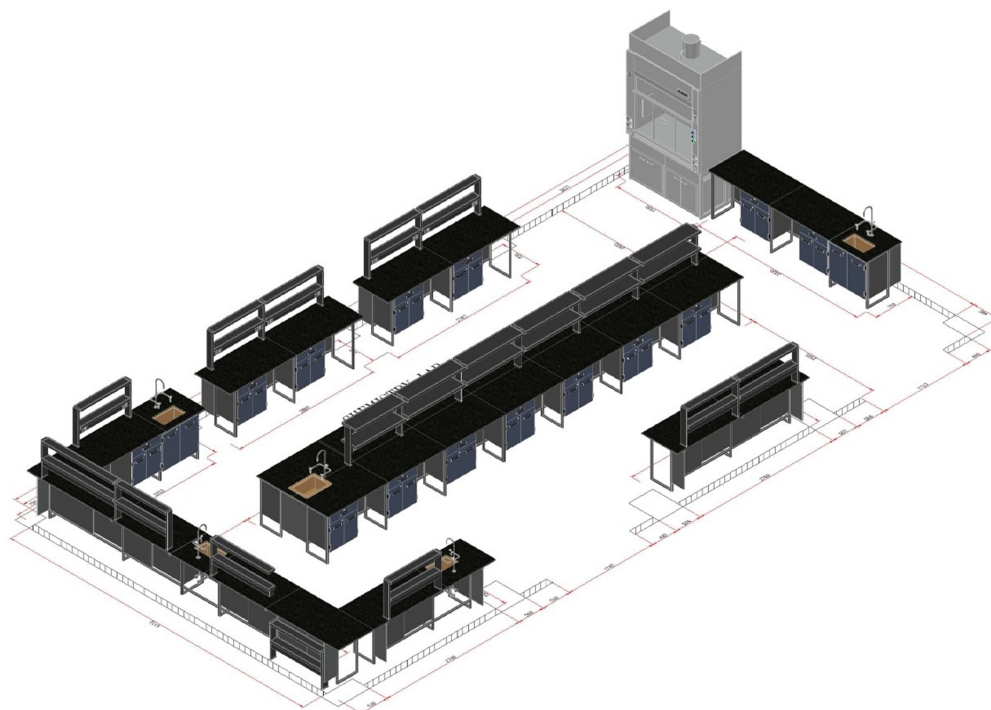

| S/N | Description of items with specifications | Qty | Unit | Rate/Unit | Total amount(₹) |
|-----|---|-----|------|-----------|-----------------|
| 1 | Wall table of 2762mmW*750mmD*900mmH with Storage, Reagent Shelves as shown in the layout | 1 | | | |
| 2 | Wall table of 2800mmW*750mmD*900mmH with Storage, Reagent Shelves as shown in the layout | 1 | | | |
| 3 | Wall table of 2253mmW*750mmD*900mmH with Sink, Storage, Reagent Shelves as shown in the layout | 1 | | | |
| 4 | Wall Table of 5014mmW*750mmD*900mmH with Sink, Storage, Reagent Shelves as Shown in the layout | 1 | | | |
| 5 | Wall Table of 2555mmW*750mmD*900mmH with Sink, Storage, Reagent Shelves as Shown in the layout | 1 | | | |
| 6 | Wall Table of 2769mmW*750mmD*900mmH with Storage, Reagent Shelves as Shown in the layout | 1 | | | |
| 7 | Wall Table of 3320mmW*750mmD*900mmH with Sink, Storage, Reagent Shelves as Shown in the layout | 1 | | | |
| 8 | Island Bench 8690mmW*1500mmD*900mmH with storage, Sink, reagent shelves as Shown in the layout. | 1 | | | |
| 9 | 5ft Fume hood of 1500mmW*900mmD with blower and ducting. | 1 | | | |

Sub Total:

- All D-Frames assemblies should be manufactured from standard hollow metal sections; confirming to I.S. Code 7138:1973 (Indian Standard specification for steel tubes for furniture) and all sheet metal components should be of CRCA confirming to IS Code 513:1994. The suspended under-bench welded units should be supported on heavy-duty steel frames fully carrying the load of worktops. Its superior strength combined with aesthetically appealing end caps shall give maximum flexibility and modularity while making a layout. D-frame should be constructed from a rectangular pipe with a cross section of 30mm x 30mm and should be a minimum 1.6 mm thick. The D-frame legs should be supplied with adjustable feet (tolerance from -5mm to +20mm) to correct the unevenness of flooring. The tubular enclosed type construction shall discourage dust accumulation and unwanted development of bacteria & fungus. Drainage gradient should be well adjusted throughout the length of table and should have horizontal supports for drainage systems... It should be suitable for sitting and standing nominal heights of 900MM, the nominal table depths should be 1500mm for Island tables. All frame-work is should be pre-treated with superior pure epoxy powder coated finish. The D-Frames should be for suspended storage cabinets.
- HORIZONTAL MEMBERS -These should be made from rectangular pipes of 2mm thickness. Cross-sectional dimensions of the pipe should be 30 x 30mm with a minimum of 1.6 mm. They should be made of CRCA MS and coated with pure epoxy powder. These connect two D-Frames together as shown using C-clamps/U-clamps. Together with the D-Frames and Horizontal Members connected together, the skeletal structure of the work-bench is formed on which the worktop can be placed and the hanging-type storage cabinets can be suspended. Horizontal Members determine the width of the lab workbench as they form the member (distance) between two adjacent D-Frames.
- COVER PANELS
All side cover panels and back panels, filler panels should be made from CRCA MS panels of minimum 0.8mm thickness with pure epoxy powder coating.
- WELDED UNDER-BENCH STORAGE CABINETS- Under bench cabinets are Pure epoxy powder coated with thickness of 40-60 microns and are suspended from tubular structure, with an overlay shutter. The cabinet has a corrosion resistance magnetic strip as shutter catch, shutter and drawer are equipped with 180 degree cam lock. Semi recessed handle and SS-304 five knuckle overlay hinge with 270 degree opening
Unit Construction: Welded body with load bearing members such as top, bottom and stiffeners should have a

minimum thickness of 0.8mm and drawer separator is 1.2mm thick. Shelf: is made of 0.8mm thickness which is adjustable to 6 steps of 50mm. Shutter is over-closing with 270 degree opening. It has a sandwich construction with profile as a sound dampener. Drawer: Welded filled with profile as sound dampener Single piece construction with an over closing drawer.

- WORKTOP- \It should be 16mm (+/- 2mm) thick Jet Black Granite worktop. The exposed edges of the worktop should be chamfered and smoothened. The bottom of the worktop should be polished and there should be a V-groove throughout the length of the exposed edges to protect the cabinets from coming in contact with the spillages. The overhang on the storage cabinet is 25 mm at the front side and 30 mm at the sides. The backing material used is a neoprene mat of 6 mm thickness. A representation the worktop edges is shown above.
- REAGENT SHELVES: Fixed-Type reagent shelves should be provided. It should be complete modular design consisting of 2 stage horizontal storage shelves made of minimum 1.2 mm thick frame. CRCA MS with pure epoxy powder coating and having cutouts for electrical switches and sockets. It should have provision for placing Granite pieces (as per requirement in BOQ).
- Polypropylene Molded Sinks: Made up of 5 mm thick high density and elastic poly propylene with good resistance to organic solvents. Standard bowl size (L x W x D) is 500 x 400 x 300 mm. Faucet should be 1-way type faucet of approved make.
- OEM Should Have SEFA Membership Certificates for Last four years on a continuous basis. Welded Cabinets should be tested for SEFA 8M from SEFA approved Lab and should be listed in SEFA's website also should be tested for EN 14727 by NABL approved Lab. And, adaptable work bench should be tested for SEFA 10 by SEFA approved Lab and should be listed in SEFA's website and also should be tested for EN 13150 by NABL approved Lab. The bidder/parent company should possess the key professional staff, at least one, in his organization with good knowledge of codes and standards like SEFA, OSHA, EN 14175, ASHRAE 110 and NFPA 45. Such professionals should have a valid membership of SEFA and in addition membership of any of the international governing standards. OEM should be present with warehousing facility in NE region since last 10 years. OEM should be a member of IGBC and should be certified under IGBC Green Existing building rating system, Platinum certified and Net zero energy building rating system.
- For Fume hood: Superstructure Frame – It should be a free-standing rigid panel structure of steel (G.I.)
- Interior Walls - Double wall ends, not more than 6" wide, should be provided to maximize interior working area. The area between the double wall ends should be closed to house the remote-control valves. Cut-outs should be provided inside the fume hood for service line accessibility. The same to have a cover with a fastener free design. The vertical fascias shall contain the required service controls, electrical switches and receptacles.
- Airfoil - A streamlined airfoil should be integral at the bottom of the hood opening on bench and distillation hoods. This foil shall provide a nominal 20mm open space between the foil and the top front edge of the work surface to direct an air stream across the work surface to prevent back flow of air. The sash should be provided with a separate handle which also provides for air flow when in completely closed position. The foil should be of 1.2mm steel to resist denting and flexing.
- Baffles - A stable, non-adjustable baffle with a single slot on the back baffle to aid in distributing the flow of air into and through the hood. The baffle should be spaced out from the back liner and should be removable for cleaning.
- Duct Collar - A 8"-10" diameter polyethylene funnel shaped rectangular duct collar should be located in the top of the hood plenum chamber.
- Lighting- Two CFL tubes of 40 watts each should be provided in the fume hood. The lighting fixture should be completely outside the fume hood area.
- Sash - A combination sash should be provided. The sash should have horizontal sliding glass panels in a vertical rising steel frame. The bottom of the sash frame should have a full-length metal handle. The sash track has minimum protrusion to avoid any kind of turbulence. The sash should be counterbalanced with a weight to prevent tilting and binding during operation. The glass panels should be 5mm toughened glass mounted in a levelled channel with roller for smooth operation.
- Plumbing Services - Utility services like Vacuum, Nitrogen, Compressed Air & Raw water (as per Schedule of Quantity) shall consist of remote-control valves as selected located within the end panels, controlled by in and out facility with flexible hose passing through the side panels of the hood, with color coded plastic handles. Interior fitting for gases and water should be with powder coated brass. All gas valves for regular lab gases to have standard needle valve and push and turn type arrangement for all burning gases should be supplied. All supplied valves to clear the following pressure test conditions: Gas Fittings – 7 bar, Water fittings – 10 bars.
- Electrical Services – The hood superstructure should be fully wired and should have a control box with MCB blower starter all safety devices like trip etc. Inlet should be of 3 phase power supply and the whole electrical should be of plug and play type. It also has 4 nos. electrical sockets and switches of Northwest make (230V, 5/16 A, 50 Hz)
- Liner – Interior liner panels should be 6 mm thick Phenol resin based industrial laminate.
- Lattice Rod Assemblies - 12mm dia solid SS rods should be clamped with the PP clamps to form a lattice

arrangement to hold the test samples and rotors within the fume hood.

- Centrifugal Blower – Silent high efficiency remote blower consisting of continuous rating motor and chemical resistant impeller. The blower should be designed to give a face velocity at safe working height as per the international safe velocity norms. (ANSI/AIHA Z9.5). The blower body should be polypropylene UV treated, high density and chemical (corrosion) resistant and mounted on a metallic stand.
- Ducting – Rigid Ducting of PP (Polypropylene) + FRP (Fiber Reinforced Polyester) and flexible ducting with flanges, bends, damper transitions, clamps etc. Flexible joint should be provided in the ducting in order to avoid transmitting the blower vibrations to the hood. A weather proof rain cowl is provided at the outlet of blower.
- Base Cabinets – Fume hoods are designed to rest on a bench (high base stand, pedestal or a cabinet) which is a complete rigid steel structure. Gauge of steel used in its construction should be 0.8 mm GI for apparatus storages.
- Ceiling Enclosures - Use to enclose space between front top and ceiling of Concept fume hood superstructure also provides enclosure for raised sash
- Transition – Used to connect fume hood with ducting. They are designed to reduce the static pressure and are made up of Poly-propylene of 6 mm thickness.
- Work Surface – Standard hood work surface should be 18mm thick jet-black granite made in the form of a watertight pan, not less than 7 mm deep to contain spillage. Worktop will have oval shaped 102 mm X 175 mm 'PP' Cup-Sink for drainage. Top should be manufactured at the same manufacturing location as the fume hood to assure proper cut-out alignment and coordinated shipping. The work surface and cup drain should be available in black.
- Product Certification: Should be SEFA 10 (Scientific Equipment and Furniture Association) Certified OEM Certification: OEM should be a member of SEFA (Scientific Equipment and Furniture Association) since last 5 years.

Taxes and Charges

| S/N | Particulars | Amount (₹) |
|-----|--------------------------------|------------|
| 1 | GST @% | ₹ |
| 2 | Packing & Forwarding | ₹ |
| 3 | Transportation | ₹ |
| 4 | Installation and Commissioning | ₹ |
| 5 | Any other charges (Specify) | ₹ |
| 6 | Total Taxes & Charges | ₹ |

Grand Total

| S/N | Particulars | Amount (₹) |
|-----|------------------------|-------------------|
| 1 | Sub-total | ₹ |
| 2 | Total Charges & Taxes | ₹ |
| 3 | Grand Total in Figures | ₹ |
| 4 | Grand Total in Words | Rupees only |

III. For Physics Laboratory Furniture:

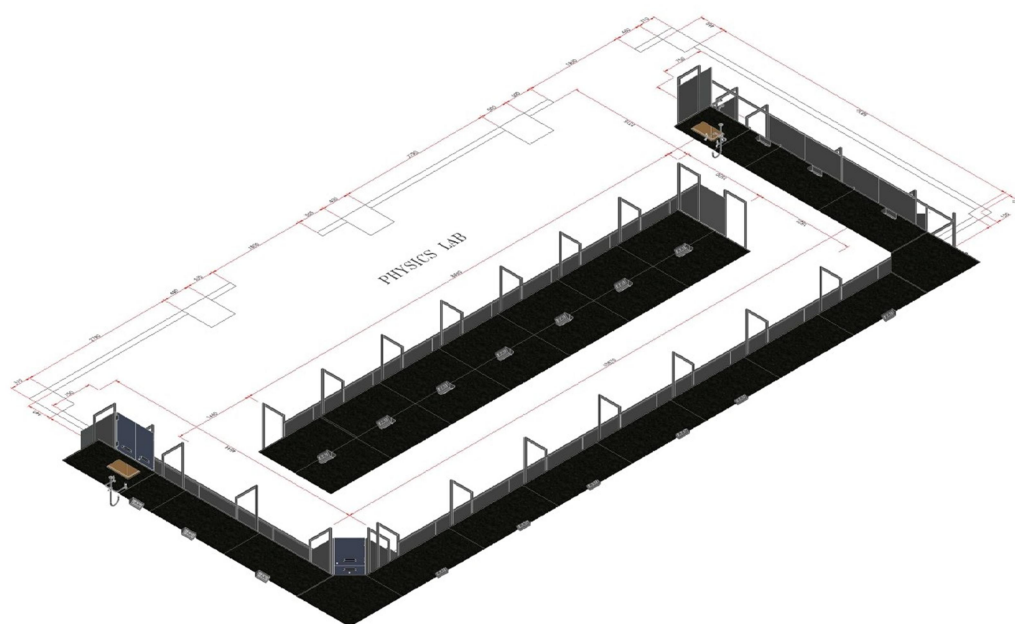

| S/N | Description of items with specifications | Qty | Unit | Rate/Unit | Total amount(₹) |
|-----|--|-----|------|-----------|-----------------|
| 1 | Wall table of 4844mmW*750mmD*900mmH, Wall table of 10870mmW*750mmD*900mmH & Wall table of 4495mmW*750mmD*900mmH with Sink and Electrical Trunking as Shown in the layout | 1 | | | |
| 2 | Island Bench 8690mmW*1500mmD*900mmH with Electrical Trunking as Shown in the layout | 1 | | | |

Sub Total:

- All D-Frames assemblies should be manufactured from standard hollow metal sections; confirming to I.S. Code 7138:1973 (Indian Standard specification for steel tubes for furniture) and all sheet metal components should be of CRCA confirming to IS Code 513:1994. The suspended under-bench welded units should be supported on heavy-duty steel frames fully carrying the load of worktops. Its superior strength combined with aesthetically appealing end caps shall give maximum flexibility and modularity while making a layout. D-frame should be constructed from a rectangular pipe with a cross section of 30mm x 30mm and should be a minimum 1.6 mm thick. The D-frame legs should be supplied with adjustable feet (tolerance from -5mm to +20mm) to correct the unevenness of flooring. The tubular enclosed type construction shall discourage dust accumulation and unwanted development of bacteria & fungus. Drainage gradient should be well adjusted throughout the length of table and should have horizontal supports for drainage systems... It should be suitable for sitting and standing nominal heights of 900MM, the nominal table depths should be 1500mm for Island tables. All frame-work is should be pre-treated with superior pure epoxy powder coated finish. The D-Frames should be for suspended storage cabinets.
- HORIZONTAL MEMBERS -These should be made from rectangular pipes of 2mm thickness. Cross-sectional dimensions of the pipe should be 30 x 30mm with a minimum of 1.6 mm. They should be made of CRCA MS and coated with pure epoxy powder. These connect two D-Frames together as shown using C-clamps/U-clamps. Together with the D-Frames and Horizontal Members connected together, the skeletal structure of the workbench is formed on which the worktop can be placed and the hanging-type storage cabinets can be suspended. Horizontal Members determine the width of the lab workbench as they form the member (distance) between two adjacent D-Frames.
- COVER PANELS
All side cover panels and back panels, filler panels should be made from CRCA MS panels of minimum 0.8mm thickness with pure epoxy powder coating
- WELDED UNDER-BENCH STORAGE CABINETS- Under bench cabinets are Pure epoxy powder coated

with thickness of 40-60 microns and are suspended from tubular structure, with an overlay shutter. The cabinet has a corrosion resistance magnetic strip as shutter catch, shutter and drawer are equipped with 180 degree cam lock. Semi recessed handle and SS-304 five knuckle overlay hinge with 270 degree opening

Unit Construction: Welded body with load bearing members such as top, bottom and stiffeners should have a minimum thickness of 0.8mm and drawer separator is 1.2mm thick.

Shelf: is made of 0.8mm thickness which is adjustable to 6 steps of 50mm. Shutter is over-closing with 270 degree opening. It has a sandwich construction with profile as a sound dampener.

Drawer: Welded filled with profile as sound dampener Single piece construction with an over closing drawer

- **WORKTOP-** It should be 16mm (+/- 2mm) thick Jet Black Granite worktop. The exposed edges of the worktop should be chamfered and smoothened. The bottom of the worktop should be polished and there should be a V-groove throughout the length of the exposed edges to protect the cabinets from coming in contact with the spillages. The overhang on the storage cabinet is 25 mm at the front side and 30 mm at the sides. The backing material used is a neoprene mat of 6 mm thickness. A representation the worktop edges is shown as under
- **Electrical Trunking:** Used for housing electrical switches and sockets, data and voice points, its top panel, bottom panel of the trunking should be made from minimum of 0.8mm thick body. It should be available in both, single sided and double-sided configurations. It should be made from CRCA MS with pure epoxy powder coating. The front surface that houses the electrical points should have a slope
- **Polypropylene Molded Sinks:** Made up of 5 mm thick high density and elastic poly propylene with good resistance to organic solvents. Standard bowl size (L x W x D) is 500 x 400 x 300 mm. Faucet should be 1-way type faucet of approved make
- **OEM Should Have SEFA Membership Certificates** for Last four years on a continuous basis. Welded Cabinets should be tested for SEFA 8M from SEFA approved Lab and should be listed in SEFA's website also should be tested for EN 14727 by NABL approved Lab. And, adaptable work bench should be tested for SEFA 10 by SEFA approved Lab and should be listed in SEFA's website and also should be tested for EN 13150 by NABL approved Lab. The bidder/parent company should possess the key professional staff, at least one, in his organization with good knowledge of codes and standards like SEFA, OSHA, EN 14175, ASHRAE 110 and NFPA 45. Such professionals should have a valid membership of SEFA and in addition membership of any of the international governing standards. OEM should be present with warehousing facility in NE region since last 10 years. OEM should be a member of IGBC and should be certified under IGBC Green Existing building rating system, Platinum certified and Net zero energy building rating system.

Taxes and Charges

| S/N | Particulars | Amount (₹) |
|-----|--------------------------------|------------|
| 1 | GST @% | ₹ |
| 2 | Packing & Forwarding | ₹ |
| 3 | Transportation | ₹ |
| 4 | Installation and Commissioning | ₹ |
| 5 | Any other charges (Specify) | ₹ |
| 6 | Total Taxes & Charges | ₹ |

Grand Total

| S/N | Particulars | Amount (₹) |
|-----|------------------------|-------------------|
| 1 | Sub-total | ₹ |
| 2 | Total Charges & Taxes | ₹ |
| 3 | Grand Total in Figures | ₹ |
| 4 | Grand Total in Words | Rupees only |

IV. For Zoology Laboratory Furniture:

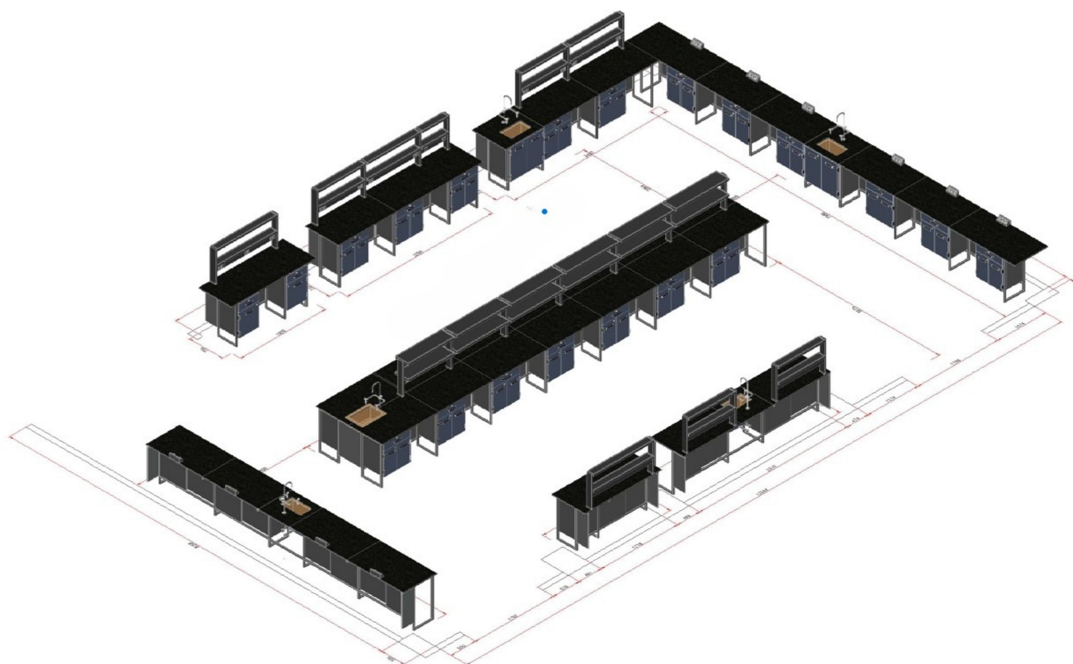

| S/N | Description of items with specifications | Qty | Unit | Rate/Unit | Total amount(₹) |
|-----|--|-----|------|-----------|-----------------|
| 1 | Wall table of 1900mmW*750mmD*900mmH Storage, Reagent Shelves as Shown in the layout | 1 | | | |
| 2 | Wall table of 7250mmW*750mmD*900mmH Storage, Reagent Shelves as Shown in the layout | 1 | | | |
| 3 | Wall table of 3450mmW*750mmD*900mmH Sink, Storage, Reagent Shelves as Shown in the layout | 1 | | | |
| 4 | Wall Table of 7988mmW*750mmD*900mmH Sink, Storage, Reagent Shelves as Shown in the layout | 1 | | | |
| 5 | Wall Table of 3310mmW*750mmD*900mmH Sink, Storage, Reagent Shelves as Shown in the layout | 1 | | | |
| 6 | Wall Table of 1718mmW*750mmD*900mmH Storage, Reagent Shelves as Shown in the layout | 1 | | | |
| 7 | Wall Table of 5780mmW*750mmD*900mmH Sink, Storage, Reagent Shelves as Shown in the layout | 1 | | | |
| 8 | Island Bench 5000mmW*1500mmD*900mmH Sink, Storage, Reagent Shelves as Shown in the layout | 1 | | | |

Sub Total:

- All D-Frames assemblies should be manufactured from standard hollow metal sections; confirming to I.S. Code 7138:1973 (Indian Standard specification for steel tubes for furniture) and all sheet metal components should be of CRCA confirming to IS Code 513:1994. The suspended under-bench welded units should be supported on heavy-duty steel frames fully carrying the load of worktops. Its superior strength combined with aesthetically appealing end caps shall give maximum flexibility and modularity while making a layout. D-frame should be constructed from a rectangular pipe with a cross section of 30mm x 30mm and should be a minimum 1.6 mm thick. The D-frame legs should be supplied with adjustable feet (tolerance from -5mm to +20mm) to correct the unevenness of flooring. The tubular enclosed type construction shall discourage dust accumulation and unwanted development of bacteria & fungus. Drainage gradient should be well adjusted throughout the length of table and should have horizontal supports for drainage systems. It should be suitable for sitting and standing nominal heights of 900MM, the nominal table depths should be 1500mm for Island tables. All frame-work is should be pre-treated with superior pure epoxy powder coated finish. The D-Frames should be for suspended storage cabinets.

- **HORIZONTAL MEMBERS** -These should be made from rectangular pipes of 2mm thickness. Cross-sectional dimensions of the pipe should be 30 x 30mm with a minimum of 1.6 mm. They should be made of CRCA MS and coated with pure epoxy powder. These connect two D-Frames together as shown using C-clamps/U-clamps. Together with the D-Frames and Horizontal Members connected together, the skeletal structure of the work-bench is formed on which the worktop can be placed and the hanging-type storage cabinets can be suspended. Horizontal Members determine the width of the lab workbench as they form the member (distance) between two adjacent D-Frames.
- **COVER-PANELS:** All side cover panels and back panels, filler panels should be made from CRCA MS panels of minimum 0.8mm thickness with pure epoxy powder coating.
- **WELDED UNDER-BENCH STORAGE CABINETS-** Under bench cabinets are Pure epoxy powder coated with thickness of 40-60 microns and are suspended from tubular structure, with an overlay shutter. The cabinet has a corrosion resistance magnetic strip as shutter catch, shutter and drawer are equipped with 180 degree cam lock. Semi recessed handle and SS-304 five knuckle overlay hinge with 270 degree opening
Unit Construction: Welded body with load bearing members such as top, bottom and stiffeners should have a minimum thickness of 0.8mm and drawer separator is 1.2mm thick.
Shelf: is made of 0.8mm thickness which is adjustable to 6 steps of 50mm. Shutter is over-closing with 270 degree opening. It has a sandwich construction with profile as a sound dampener.
Drawer: Welded filled with profile as sound dampener Single piece construction with an over closing drawer.
- **REAGENT SHELVES:** Fixed-Type reagent shelves should be provided. It should be complete modular design consisting of 2 stage horizontal storage shelves made of minimum 1.2 mm thick frame. CRCA MS with pure epoxy powder coating and having cutouts for electrical switches and sockets. It should have provision for placing Granite pieces (as per requirement in BOQ)
- **Polypropylene Molded Sinks:** Made up of 5 mm thick high density and elastic poly propylene with good resistance to organic solvents. Standard bowl size (L x W x D) is 500 x 400 x 300 mm. Faucet should be 1-way type faucet of approved make
- **OEM Should Have SEFA Membership Certificates** for Last four years on a continuous basis. Welded Cabinets should be tested for SEFA 8M from SEFA approved Lab and should be listed in SEFA's website also should be tested for EN 14727 by NABL approved Lab. And, adaptable work bench should be tested for SEFA 10 by SEFA approved Lab and should be listed in SEFA's website and also should be tested for EN 13150 by NABL approved Lab. The bidder/parent company should possess the key professional staff, at least one, in his organization with good knowledge of codes and standards like SEFA, OSHA, EN 14175, ASHRAE 110 and NFPA 45. Such professionals should have a valid membership of SEFA and in addition membership of any of the international governing standards. OEM should be present with warehousing facility in NE region since last 10 years. OEM should be a member of IGBC and should be certified under IGBC Green Existing building rating system, Platinum certified and Net zero energy building rating system.

Taxes and Charges

| S/N | Particulars | Amount (₹) |
|-----|--------------------------------|------------|
| 1 | GST @% | ₹ |
| 2 | Packing & Forwarding | ₹ |
| 3 | Transportation | ₹ |
| 4 | Installation and Commissioning | ₹ |
| 5 | Any other charges (Specify) | ₹ |
| 6 | Total Taxes & Charges | ₹ |

Grand Total

| S/N | Particulars | Amount (₹) |
|-----|------------------------|-------------------|
| 1 | Sub-total | ₹ |
| 2 | Total Charges & Taxes | ₹ |
| 3 | Grand Total in Figures | ₹ |
| 4 | Grand Total in Words | Rupees only |

Declaration

We hereby certify that the prices quoted above, for the **supply, installation and commissioning of Science Laboratory Furniture** for the departments of Botany, Chemistry, Physics and Zoology of Rabindranath Tagore University, Hojai, Assam are firm and inclusive of all charges as mentioned and are valid for a period of ____ days from the date of submission. We agree to supply, install and commission the items as per the tender terms and conditions of Rabindranath Tagore University, Hojai, Assam.

Signature and Seal

Authorized Signatory:

Name & Designation :

Date :

Company Seal

CHECK LIST

- Tender Acceptance Undertaking (Annexure – I).
- Demand Draft of ₹ 25, 000/- (Rupees Twenty-five Thousand) only as EMD.
- Demand Draft of ₹ 5, 000/- (Rupees Five Thousand) only towards Tender Fee.
- Tender documents (all annexures – I to IV) with all pages duly signed and embossed with official seal (Technical Bid).
- Financial Bid (Annexure – V) should be in a separate cover.
- Copy of Certificate of Incorporation/Registration
- Copy of PAN Card.
- Proof of registration for GSTIN.
- Work Experience Certificate along with Work Order & Completion Certificate.
- Price list/Catalogue (with two soft copies in CD)
- Any other documents the bidder feels necessary and appropriate
(Details to be mentioned)